

## 2 Turner Road - Guide Price £285,000

Stowmarket IP14 1UD

# shires

Estate & Letting Agents



*"Consistently providing outstanding service to our clients"*



# Guide Price £285,000

## The Property

Situated in a small close on the popular Chilton Hall development to the west of Stowmarket town centre is this well presented detached family home offers spacious accommodation. The property comprises Entrance Hall, Cloakroom, large L Shaped Sitting/Dining Room, Kitchen, Garden Room, 3 Bedrooms and Family Bathroom. Externally the property has a timber Garage to the side and driveway parking for three cars. It benefits from Gas Fired Central Heating and is being offered for sale with no onward chain.

## Features

- WELL PRESENTED DETACHED FAMILY HOME
- LOCATED IN A SMALL CLOSE TO THE WEST OF STOWMARKET
- GAS FIRED CENTRAL HEATING
- ENTRANCE HALL, CLOAKROOM, SITTING/DININGROOM
- KITCHEN AND GARDEN ROOM
- THREE BEDROOMS, BATHROOM
- TIMBER GARAGE & PARKING FOR THREE CARS
- ENCLOSED GARDEN
- NO ONWARD CHAIN







These sales particulars have been produced as a general guide only and we would draw to your attention that we have not carried out a detailed Survey of the property nor have we tested services, appliances or specific fittings. Whilst measurements and statements given within the details are provided in good faith, their accuracy should not be relied upon. If there are any points about which you may be uncertain or would like further clarification, we would suggest that you telephone this office and speak to our staff who will endeavour to assist you.

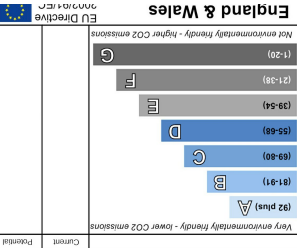
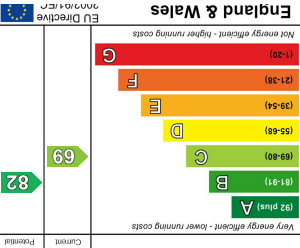

Whilst every attempt has been made to ensure the accuracy of the floorplan contained here, measurements of doors, windows, rooms and any other items are approximate and no responsibility is taken for any error, omission or mis-statement. This plan is for illustrative purposes only and should be used as such by any prospective purchaser. The services, systems and appliances shown have not been tested and no guarantee is given.

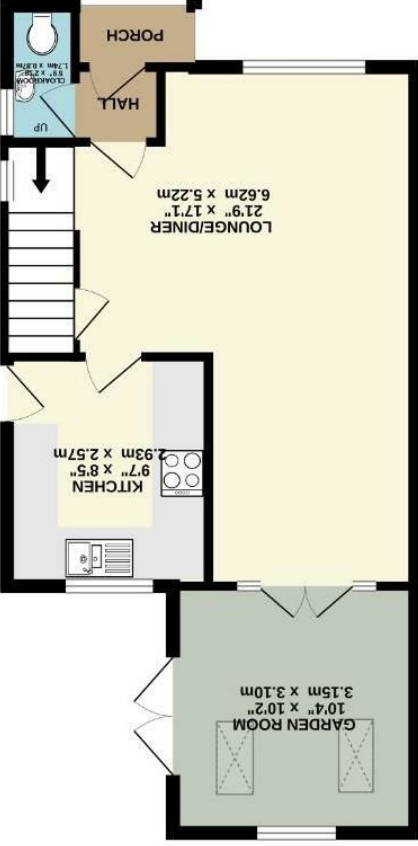

GROUND FLOOR  
497 sq.ft. (46.2 sq.m.) approx.



1ST FLOOR  
392 sq. ft. (36.4 sq.m.) approx.

Shires Residential  
45 Ipswich Street, Stowmarket, Suffolk, IP14 1AH  
T: 01449 673948  
E: [stowmarket@shiresstateagents.co.uk](mailto:stowmarket@shiresstateagents.co.uk)  
[www.shiresresidential.com](http://www.shiresresidential.com)

E: [stowmarket@shiresstateagents.co.uk](mailto:stowmarket@shiresstateagents.co.uk)  
[www.shiresresidential.com](http://www.shiresresidential.com)